

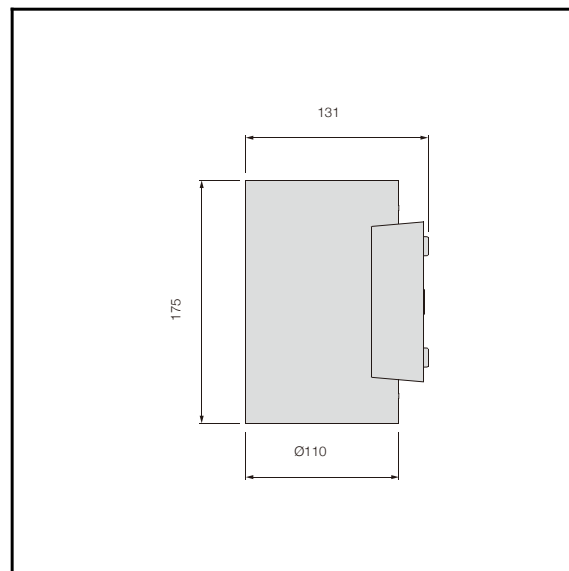

The photograph may not match the reference exactly.  
Please read the product description to identify the finish.



## TECHNICAL CHARACTERISTICS



Type:	Wall Lighting
IP Protection degrees:	IP65
IK Protection degrees:	IK08
Light source 1:	2x LED COB 20W 3000 / 4200K 1668lm <sup>(N)</sup> CRI 75
Total power consumption (W):	20.2
Voltage / Frequency:	100-240V/50-60Hz
Warranty (Years):	5
Units per box:	4
	1.7

## MATERIALS / FINISHES

<b>Structure material:</b> High purity aluminium	<b>diffuser material:</b> Glass
<b>Structure finish:</b> Dark grey	<b>Diffuser finish:</b> Transparent

## GEAR

Multi-voltage electronic gear included (110-240 V / 50-60 Hz)

Lm<sup>(N)</sup>: Nominal flow of light in actual working conditions. Its actual flow will depend on the environmental conditions and the efficiency of the optics and/or diffuser.

Kled reserves the right to make the necessary technical changes they deem adequate, in order to improve the features of the product.  
Please consult the sales team to clarify any doubt.

Tel.: +86 574 62566 890  
Email: info@kled.com.cn  
<http://www.kled.com.cn/>

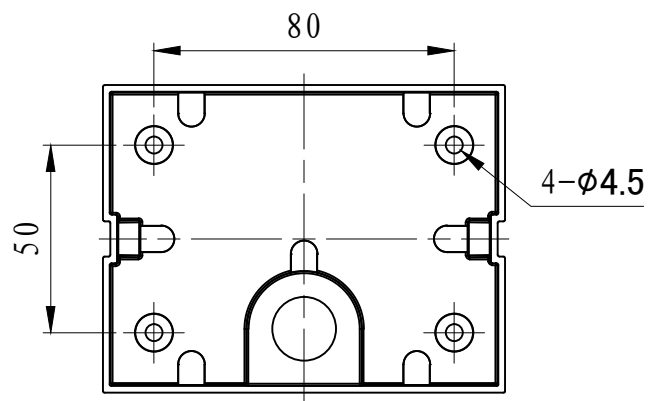
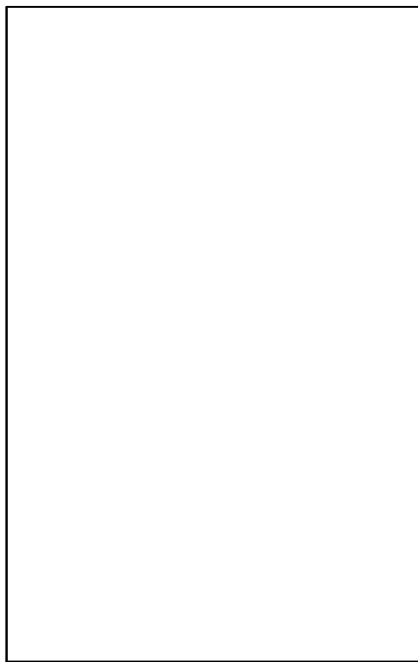
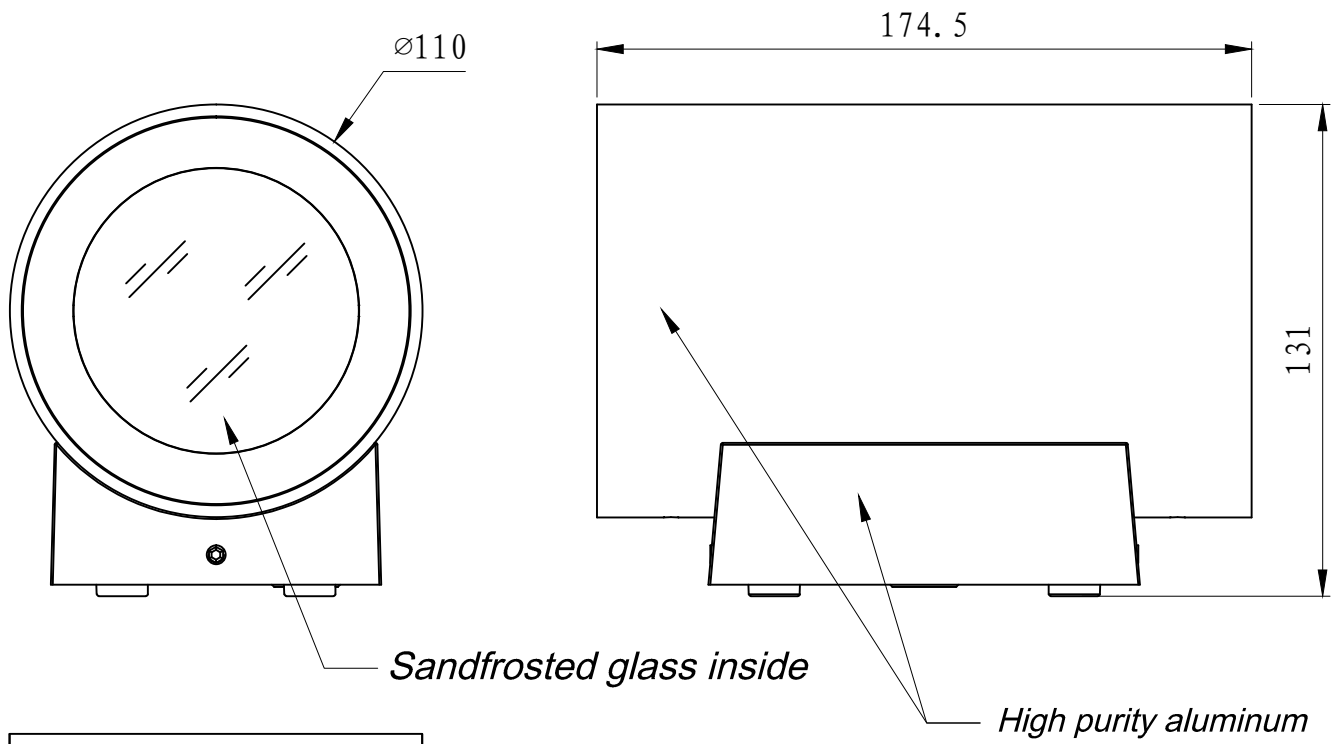

*Installation template*